

ANSI / ASME B18.2.2

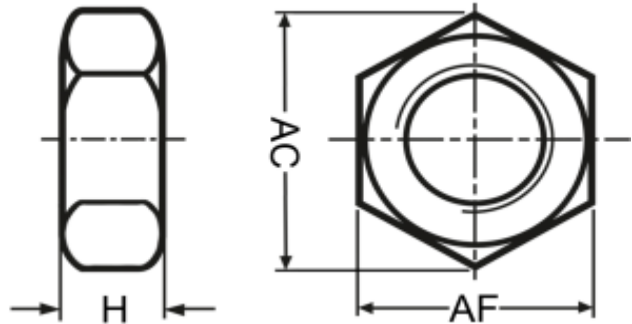

## Grade 5 & Grade 8 Hex Full Nut Dimensionen

Gewindegröße	Width Across Flat (AF)		Width Across Corner (AC)		Höhe (H)	
	Inch	mm	Inch	mm	Inch	mm
1/4	7/16	11,112	0.505 - 0.488	12.83 - 12.40	7/32	5,556
5/16	1/2	12,700	0.577 - 0.557	14.66 - 14.15	17/64	6,747
3/8	9/16	14,288	0.650 - 0.628	16.51 - 15.95	21/64	8,334
7/16	11/16	17,463	0.794 - 0.768	20.17 - 19.51	3/8	9,525
1/2	3/4	19,050	0.866 - 0.840	22.00 - 21.34	7/16	11,112
9/16	7/8	22,225	1.010 - 0.982	25.65 - 24.94	31/64	12,303
5/8	15/16	23,812	1.083 - 1.051	27.51 - 26.70	35/64	13,890
3/4	1-1/8	28,575	1.299 - 1.240	32.99 - 31.50	41/64	16,272
7/8	1-5/16	33,338	1.516 - 1.447	38.51 - 36.75	3/4	19,050
1	1-1/2	38,100	1.732 - 1.653	43.99 - 41.99	55/64	21,828
1 1/8	1-11/16	42,862	1.949 - 1.859	49.50 - 47.22	31/32	24,606
1 1/4	1-7/8	47,625	2.165 - 2.066	54.97 - 52.48	1-1/16	26,987
1 3/8	2-1/16	52,387	2.382 - 2.273	60.50 - 57.73	1-11/64	29,766
1 1/2	2-1/4	57,150	2.598 - 2.480	65.99 - 62.99	1-9/32	32,544
1 5/8	2-7/16	61,912	2.815 - 2.686	71.50 - 68.30	1-25/64	35,322
1 3/4	2-5/8	66,675	3.031 - 2.893	76.99 - 73.48	1-1/2	38,100
2	3	76,200	3.464 - 3.306	87.99 - 83.97	1-23/32	43,656

Maße können durch Toleranzen bei der Fertigung von Massenteile abweichen

